

ALCATEL

home & business phones

ALCATEL T60



USER'S GUIDE

ATLINKS Europe, 22 quai Gallieni 92150 Suresnes - France
Alcatel Logo and Alcatel name are trademarks of Alcatel Lucent and used under license by Atlinks.

INTRODUCTION

Your Caller ID phone stores and displays specific information, provided by your local telephone company, to subscribers of Caller ID or similar caller identification services.

Your Caller ID phone enables you to:

- Identify callers before you answer the phone.
- View the time and date of each incoming call.
- Record up to 58 Caller ID name and number messages sequentially.

MAIN FEATURES

- FSK/DTMF auto detect.
- Alphanumerical backlight display.
- 6 languages interface selection.
- Record up to 58 incoming caller names and numbers.
- Record up to 10 recent dialed numbers.
- 10 two-touch memories.
- 4 one-touch memories.
- Redial.
- Pulse or Tone dialing mode.
- Flash timing selectable.
- Mute function.
- Speakerphone.

To get the most from your new phone, please read through this user's guide.

SHORT GLOSSARY OF TERMINOLOGY USED IN THIS MANUAL

Hook switch. The part of the phone that pops up to activate the phone line when the handset is lifted from the base.

Off-hook. The phone is in active mode when the handset is off the base cradle or the **SPEAKER** feature is on.

On-hook. The phone is in standby mode when the handset is on the base cradle.

PARTS CHECKLIST

Your package includes the following items:



User's Guide Base Handset Coiled cord Line cord

NOTE: If there is any item missing in the package, please contact the shop where you bought this product.

TELEPHONE JACK REQUIREMENTS

To use this phone, you need a RJ11C type modular telephone jack, (similar to the one pictured here) installed in your home. Call your local phone company to have one installed.

Wall plate



Modular telephone line jack

INSTALLATION

CAUTION: Disconnect the phone cord from the wall outlet before installing or replacing the batteries.

- Never install telephone wiring during a lightning storm.
- Never touch un-insulated telephone wires or terminals, unless the telephone line has been disconnected at the network interface.
- Install or modify telephone lines with caution.
- Never install telephone to operate in wet or damp locations.

INSTALLING AND REPLACING THE BATTERIES

Your Caller ID phone uses 3 AA-Size alkaline batteries for receiving and storing Caller ID records and storing the number.

IMPORTANT: If you are not going to use the telephone for more than 30 days, remove the batteries.

BATTERY

1. If the telephone line cord is connected, disconnect it from the base unit.
2. Carefully turn the phone over, use a pen or paper clip to loosen the battery cover. Open the battery compartment by pushing on the battery cover and sliding it away from the unit.
3. Insert 3 AA-size alkaline batteries (not included) as shown on the engraving in the battery compartment.
4. Snap the battery compartment door back into place.
5. Reconnect the telephone line cord to the base.

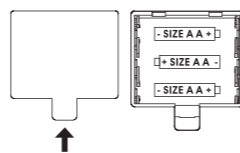

INSTALLING THE PHONE

Your phone should be placed on a level surface, such as a desk or table top, or you can mount it on a wall.

1. Connect the handset.
2. Connect the telephone line.

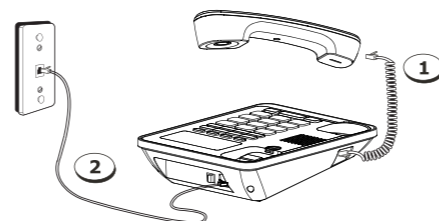

WALL MOUNTING

1. Rotate the wall mounting knob as shown below:

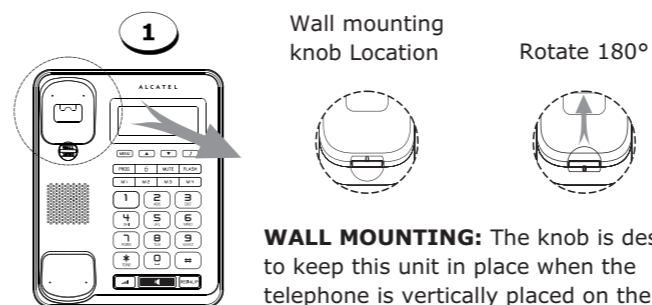

Wall mounting knob Location Rotate 180°

WALL MOUNTING: The knob is designed to keep this unit in place when the telephone is vertically placed on the wall.

2. Install the base unit to the wall and then plug one end of line cord into the base and the other end into the modular telephone line jack.

3. Fix the telephone on the wall as shown below.

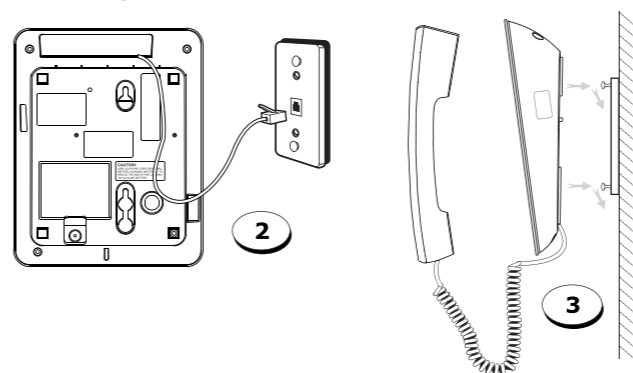

OPTIONS MENU

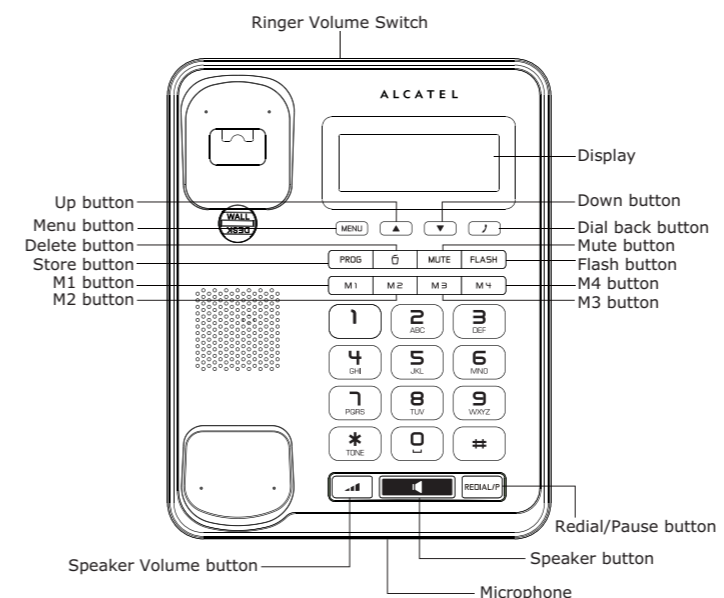
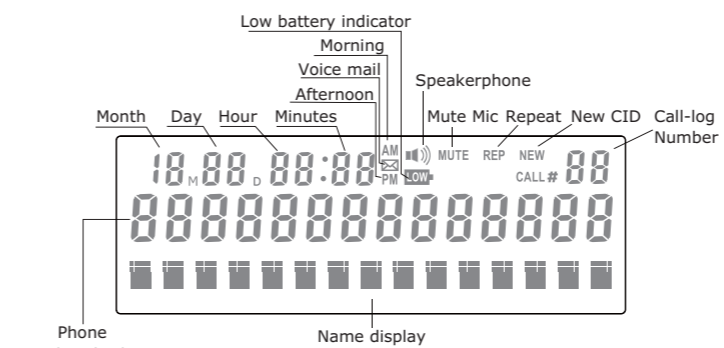

SETTING THE PHONE

NOTE: Program the following settings before using the phone.

There are 6 options to set:

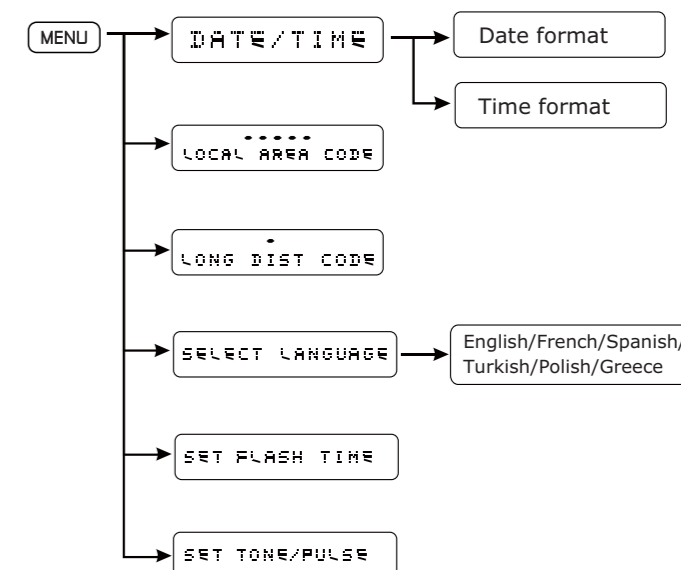

SETTING DATE/TIME

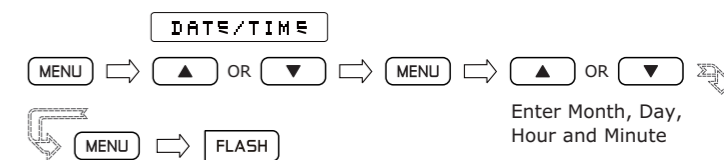

SETTING LOCAL AREA CODE

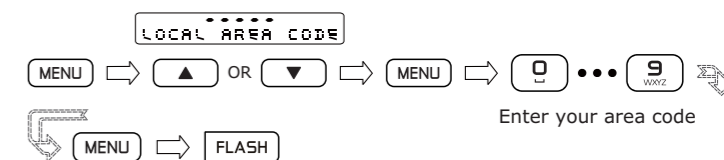

The area code prior to an incoming number will be removed from the caller ID display if it matches with the area code you set.

SETTING LONG DIST CODE

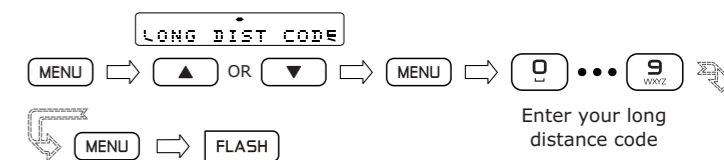

SETTING LANGUAGE

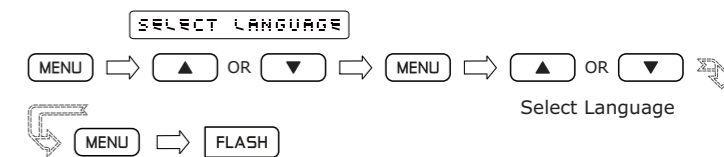

SETTING FLASH TIME

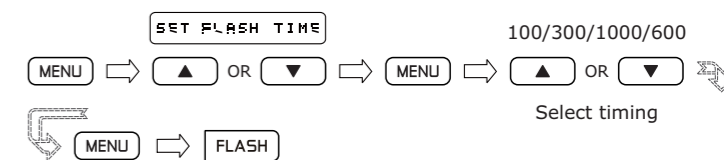

SETTING TONE/PULSE

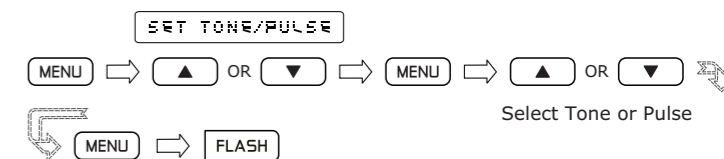



PHONE OPERATION

RECEIVING A PHONE CALL

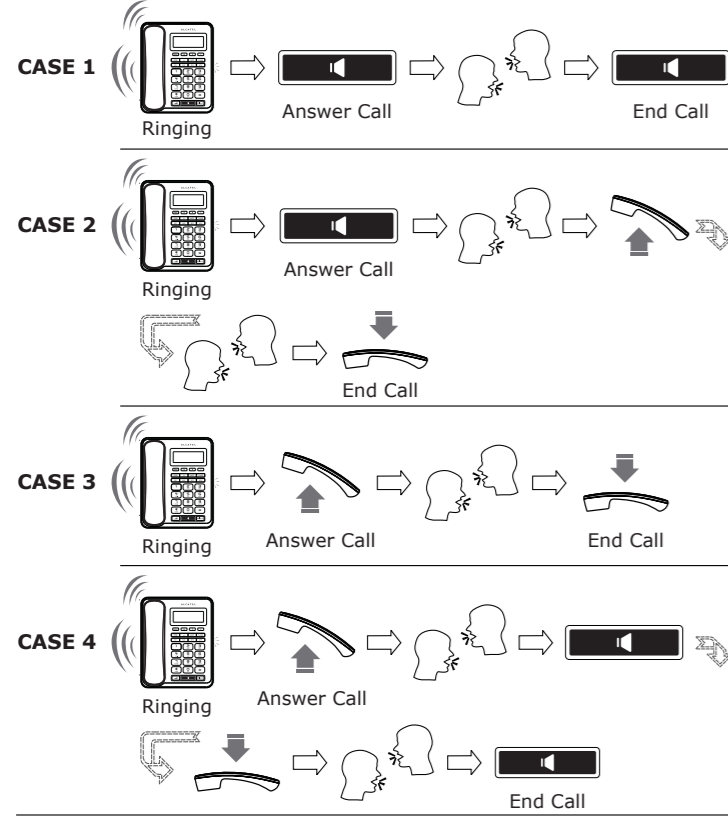

MAKING A PHONE CALL

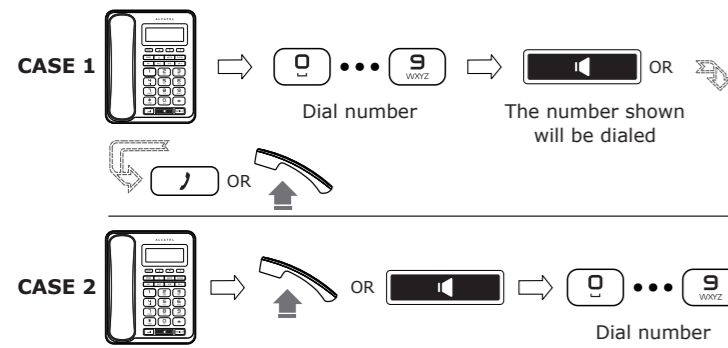

P=>T DIAL MODE

In PULSE dialing mode, press [*] button to switch to TONE dialing.

REDIAL

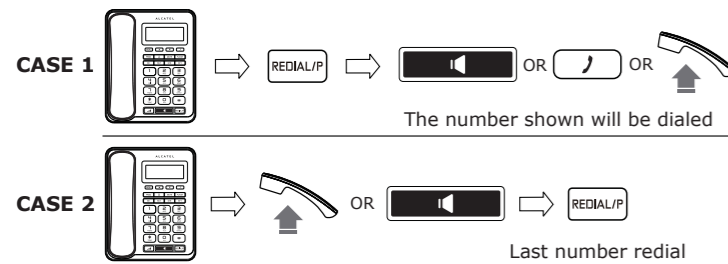

MUTE

Press the **MUTE** button to mute a call, when **MUTE** is on, the **MUTE** indicator will show on the screen. Press the **MUTE** button again to resume normal conversation.

SPEAKER VOLUME LEVEL ADJUSTMENT

User may adjust speakerphone volume level during conversation by pressing the VOL button.

RINGER VOLUME LEVEL

Use the ringer volume switch indicated as **A** on the picture shown below to select the ringer volume from HI or LOW.



CALLER ID FEATURES

Caller ID (CID) is a service provided by your local telephone company. You have to subscribe this service from your local telephone company before you can use it. This unit can receive caller ID without any setting. Your caller ID information may include the phone number, name, date and time.

REVIEWING INCOMING CALLS

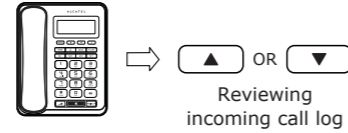

DIAL BACK A CALLER ID NUMBER

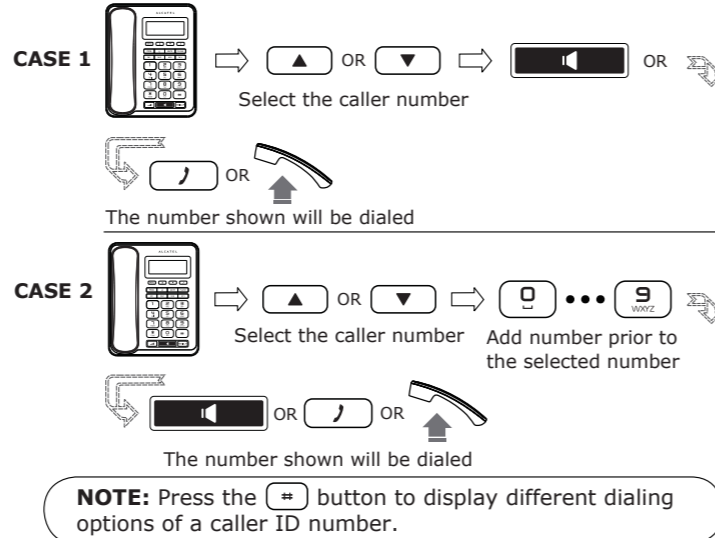

DELETING A CALLER ID NUMBER

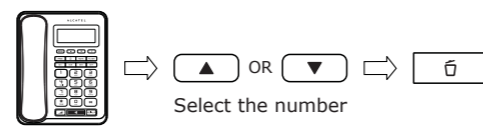

DELETING ALL CALLER ID NUMBER

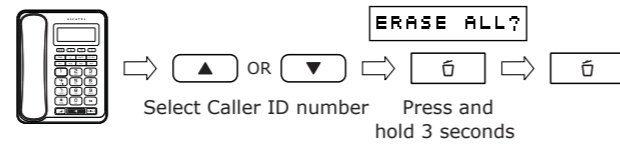

REVIEWING OUTGOING NUMBERS

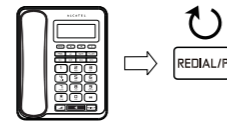

DIAL BACK AN OUTGOING NUMBER

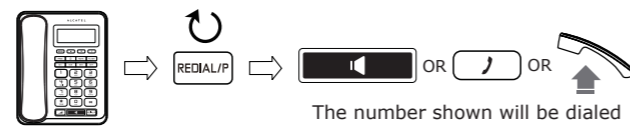

DELETING AN OUTGOING NUMBER

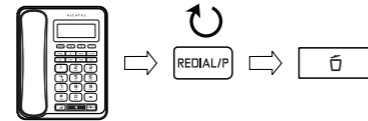

DELETING ALL OUTGOING NUMBER

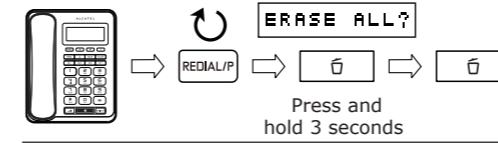

CHARACTER TABLE

key	Assigned characters	key	Assigned characters
1	1	7	P Q R S 7
2	A B C 2	8	T U V 8
3	D E F 3	9	W X Y Z 9
4	G H I 4	*	TO NE *
5	J K L 5	0	0 - -
6	M N O 6	#	#

STORING A TELEPHONE NUMBER

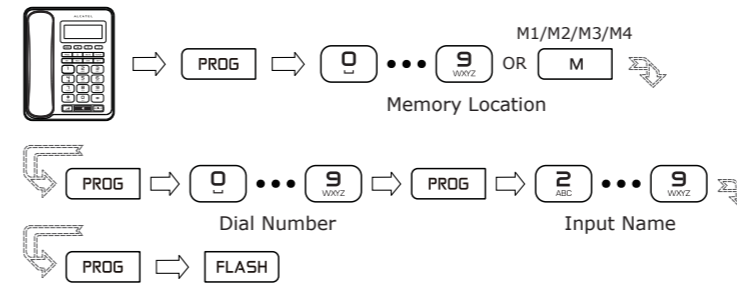

STORING AN INCOMING CALL NUMBER

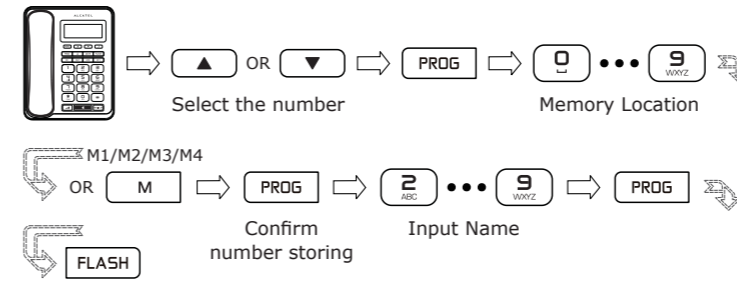

STORING AN OUTGOING NUMBER INTO MEMORY

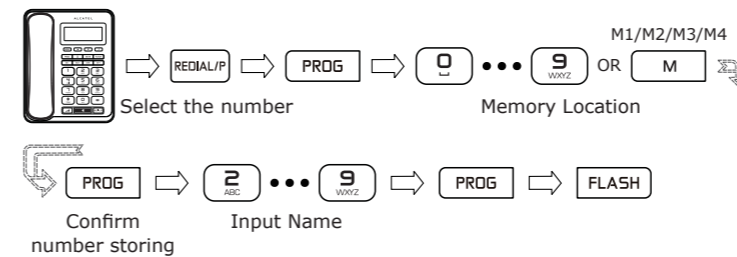

DIALING A MEMORY LOCATION

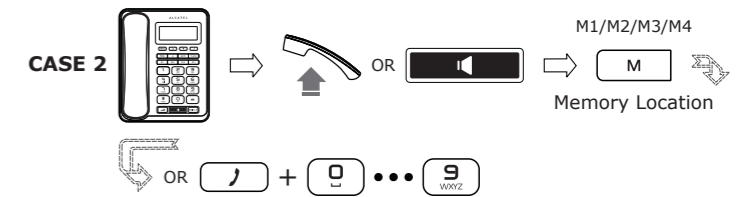
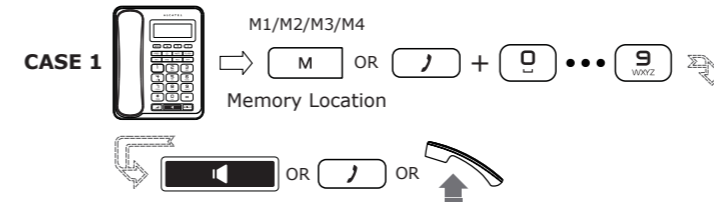

CHECK CONTENT OF MEMORY LOCATION

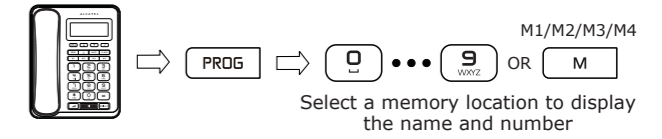

DELETING A MEMORY LOCATION

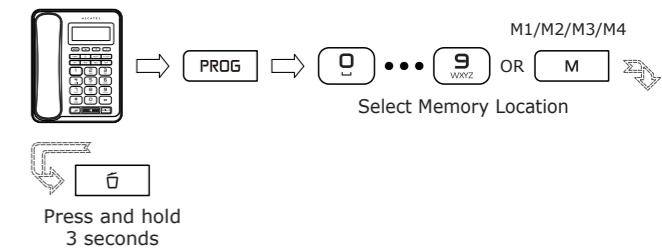

TROUBLESHOOTING TIPS

No Dial Tone

- Check all connections are secure and not damaged.
- Make sure the hook switch is fully extended when the handset is lifted from the cradle.

No Display

- Replace the batteries.
- Check for proper battery installation.

The Telephone Does Not Display Caller ID information

- Make sure you have subscribed to caller ID service from your local telephone company.
- Depending on telephone company, the caller ID information may not display until the second ring of an incoming call.

The Phone Does Not Ring

- You may have too many extension phones on one line. Try to unplug some extension phones.

Incoming or Outgoing Voice Volume is Low

- Make sure no other phone on the same line is off hook at the same time as it will influence the voice volume.
- Check the handset receiver or speaker volume.

GENERAL PRODUCT CARE

To keep your phone in good operating condition, follow these guidelines:

- Avoid placing it near heating appliances and devices that generate electrical noise (for example, motors or fluorescent lamps).
- DO NOT expose to direct sunlight or moisture.
- Avoid dropping and other rough treatment to the unit.
- Clean with a soft cloth.
- Never use a strong cleaning agent or abrasive powder because this will damage the unit.
- Retain the original packaging in case you need to ship it at a later date.



Used equipment must be disposed of in compliance with current environment protection regulations. You should return it to your reseller or dispose of it in an approved recycling center.